



**ELEVATION 01**



**ELEVATION 02**

**LOCATIONAL PLAN SCALE 1: 2500**

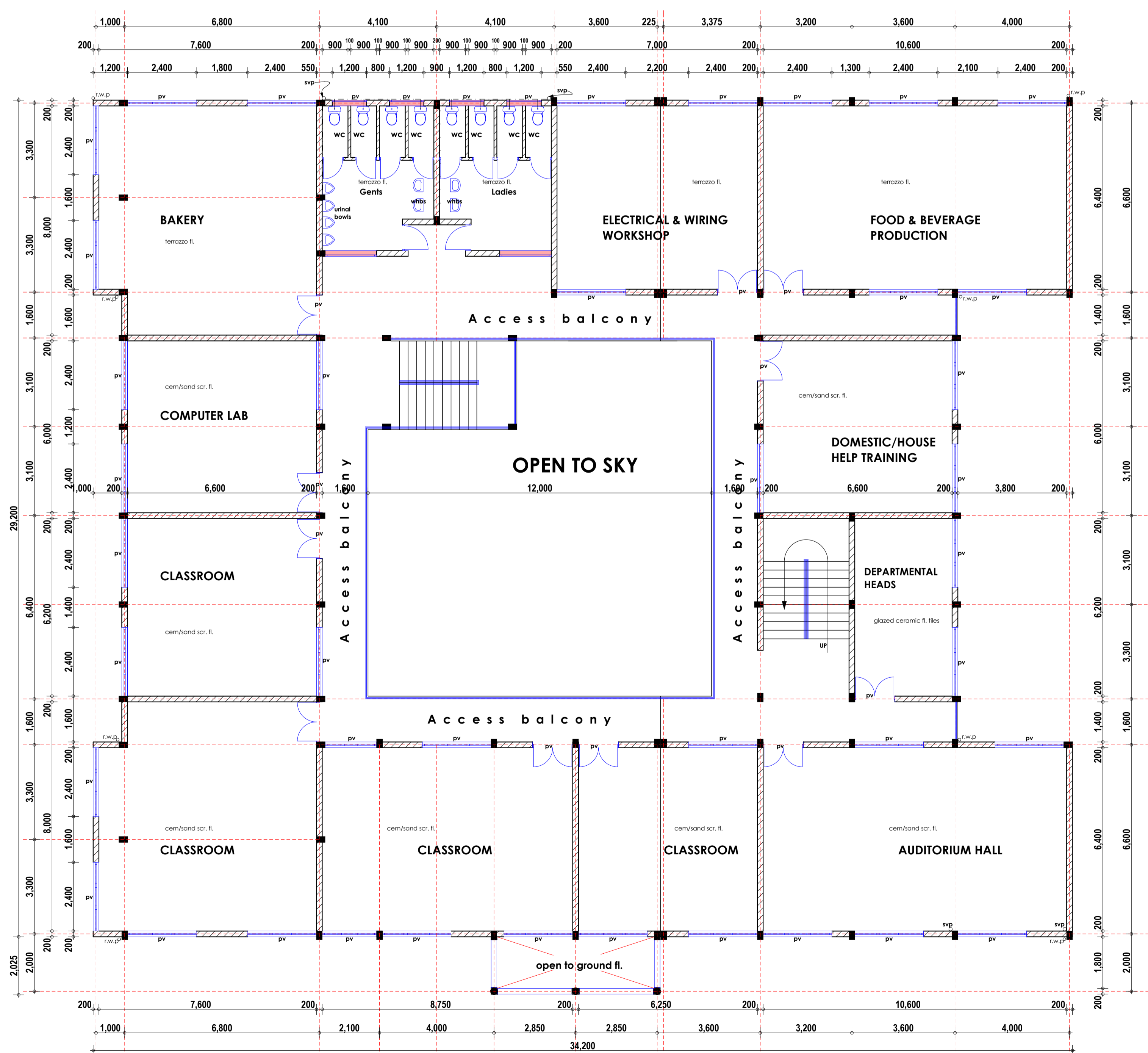

**FIRST FLOOR PLAN**

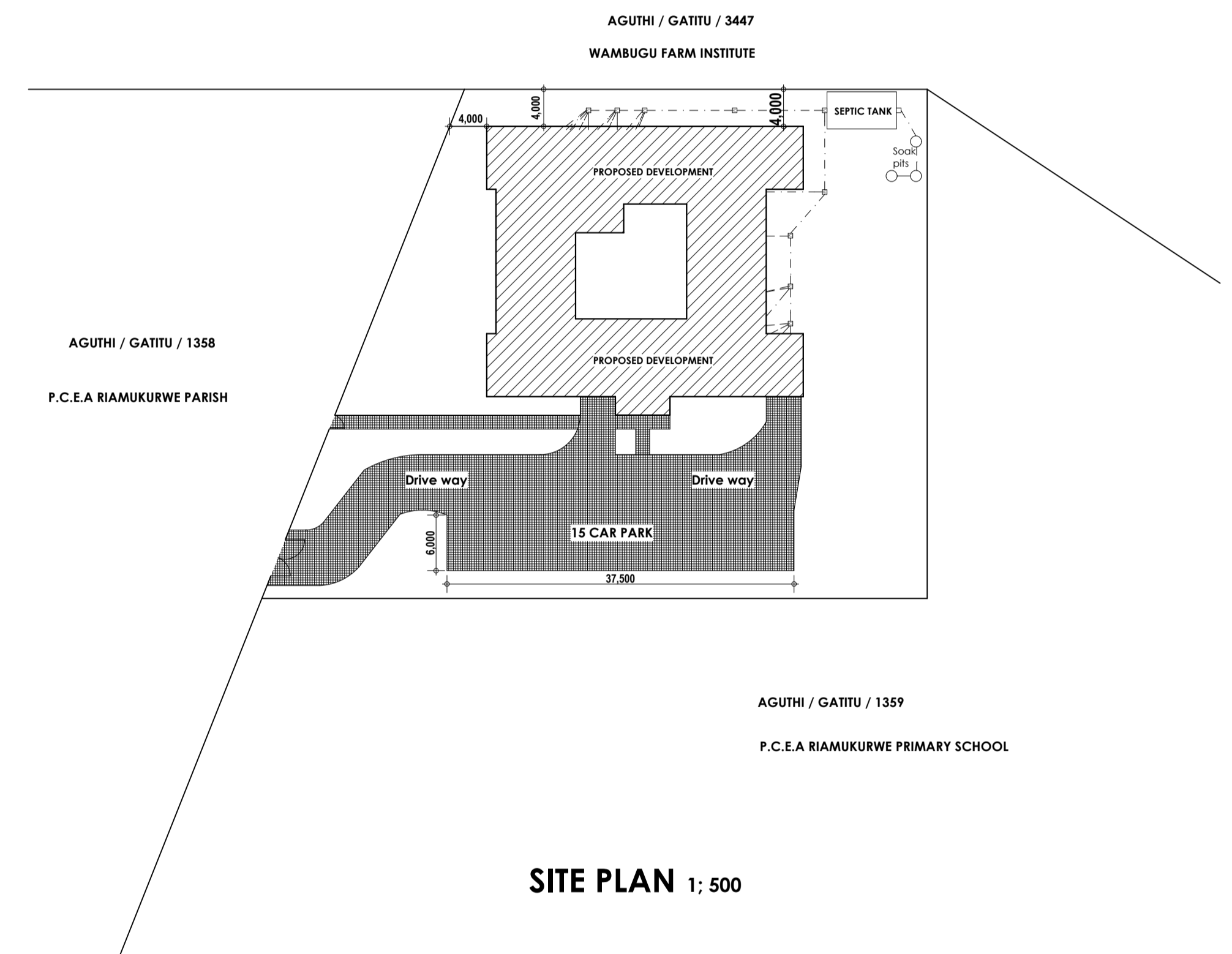

**SITE PLAN 1: 500**

**APPROVALS**

CLIENT  
**P.C.E.A RIAMUKURWE PARISH**

approval signature .....

PROJECT TITLE  
**PROPOSED VOCATIONAL TRAINING CENTRE ON Plot no. AGUTHI / GATITU / 1359**

CONSULTANTS  
**PLANTECH BUILDING SERVICES  
P.O. BOX 2320, PHONE 0722212697 NYERI**

Designed by: **D. KINYUA**

Drawn by: **D. KINYUA**

Checked by: **H. K. Njagi**

**NOTES**

All dimensions are in mm unless otherwise specified. Drawings are not to be scaled, only figured dimensions to be used. The contractor must check and verify all the dimensions before commencement of the work. All slabs at ground level to be laid over 500 gauge polythene sheeting on 50mm thick murrum blinding, on well compacted hardcore. All soils under slabs & around external foundation to be poised for the termites control. For all R.C works, refer to S.E.'s details. Foundation depths to be determined on site to the S.E approval. All walls less than 200mm thick to be reinforced with hoop iron at every alternate course. All plumbing and drainage work to comply with P.H specifications. S.V.P denotes Soil Vent Pipe to be provided at the head of the drainage. Drains passing beneath buildings and driveways to be encased in 150mm concrete surround. P.V Denotes permanent vents.

drawing type  
**WORKING DRAWINGS  
First floor Plan, Site/location plan & Elevations 1 & 2**

scale  
**1: 100, 1: 200**

date  
**July, 2008**